

al slope

No. D-3531

Benjamin K. M. Dome Reflectors with Brackets  
100 Watt Lamps - spaced at 30'

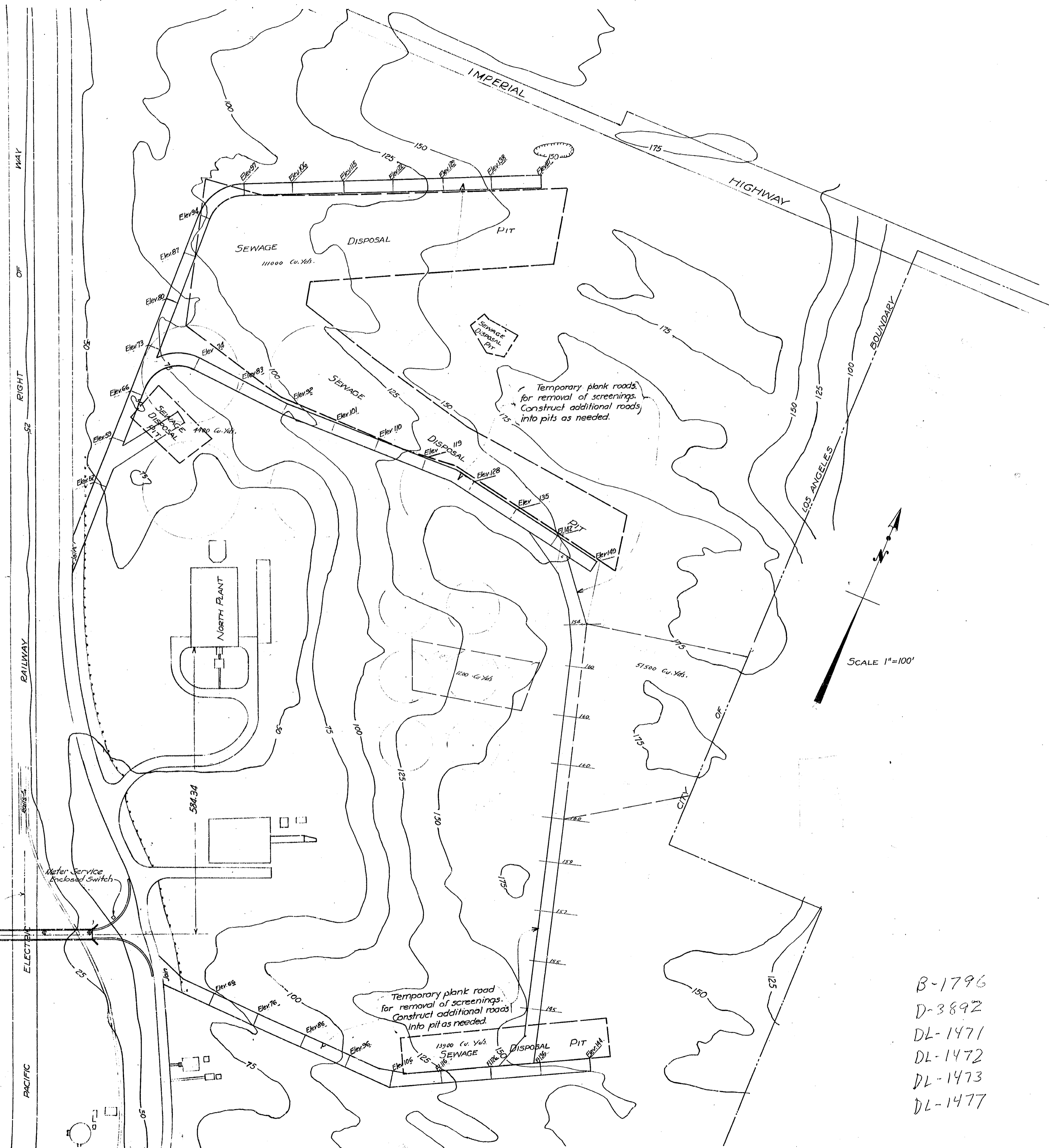

**HYPERION SEWAGE TREATMENT PLANT**  
**SCREENINGS DISPOSAL**

GENERAL PLAN  
 CITY OF LOS ANGELES  
 LLOYD ALDRICH CITY ENGINEER

SUBMITTED Oct. 12 1935  
 BY H. J. Smith  
 ENGINEER OF SEWER DESIGN  
 BY Maxwell Smith  
 DEPUTY ENGINEER (DESIGN)  
 APPROVED Oct. 4 1935  
Lloyd Aldrich  
 CITY ENGINEER

SHEET 2 OF 2 SHEETS  
 FOR DETAILS SEE PLAN NO. B-1796

HYPERION TREATMENT PLANT (NEW)  
 W.O. 36772

D-3890

B-1796  
 D-3892  
 DL-1471  
 DL-1472  
 DL-1473  
 DL-1477

3890

Designed by W. H. Smith  
 Drawn by Maxwell Smith  
 Checked by Blaine

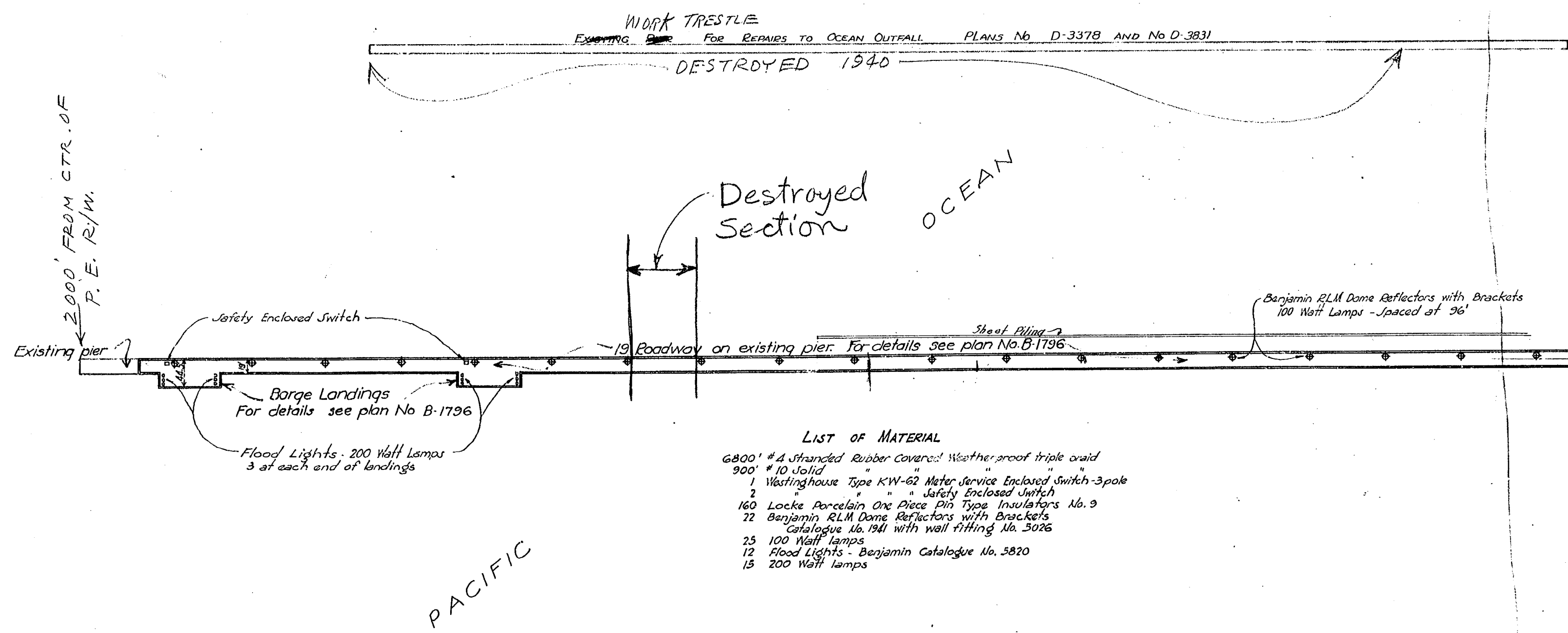
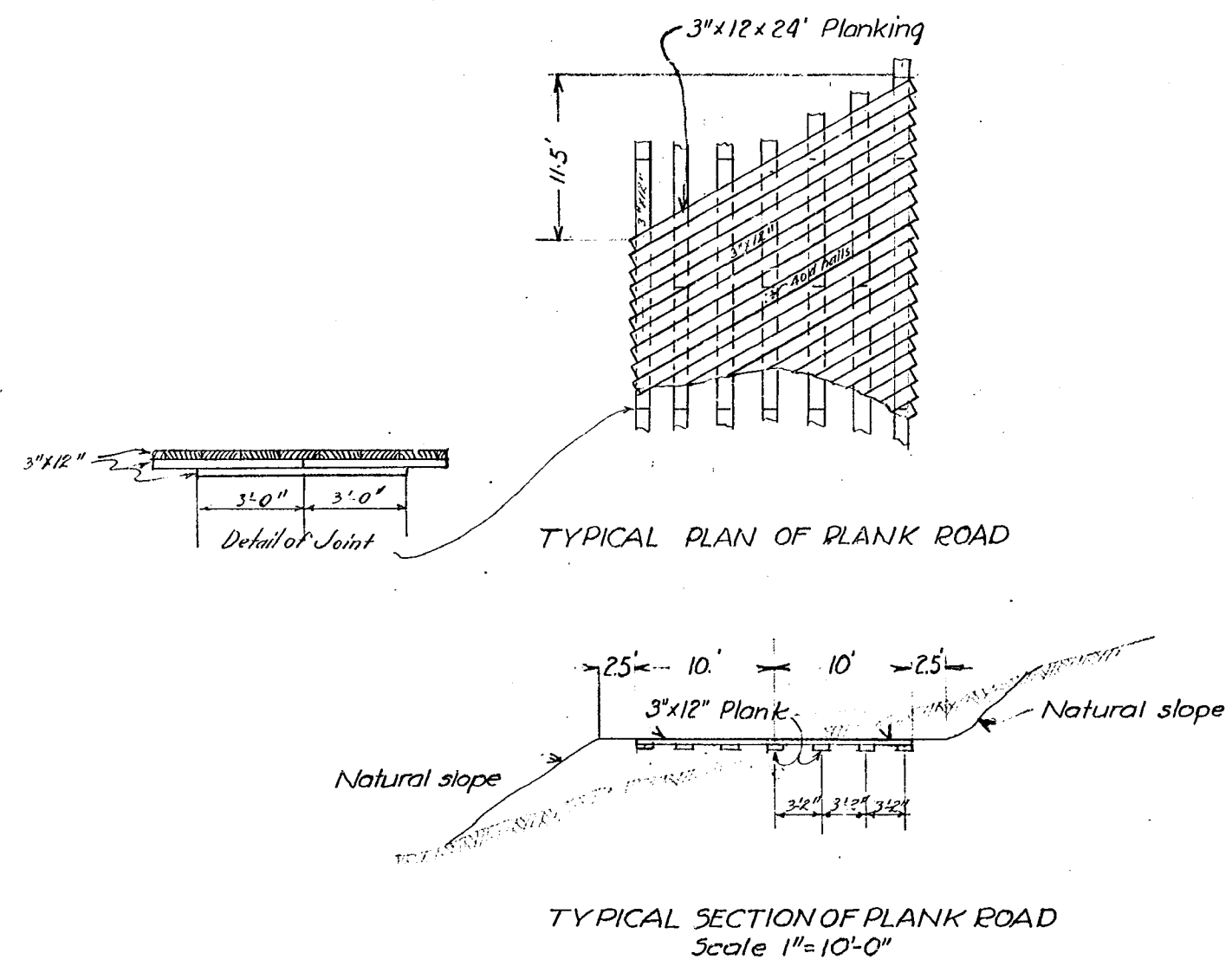

- LIST OF MATERIAL**
- 6800' #4 Stranded Rubber Covered Weatherproof triple cord
  - 900' #10 Solid
  - 1 Westinghouse Type KW-62 Meter Service Enclosed Switch-3 pole
  - 1 Safety Enclosed Switch
  - 160 Locke Porcelain One Piece Pin Type Insulators No. 9
  - 22 Benjamin RLM Dome Reflectors with Brackets Catalogue No. 1941 with wall fitting No. 5026
  - 25 100 Watt Lamps
  - 12 Flood Lights - Benjamin Catalogue No. 5820
  - 15 200 Watt lamps

